

INTELLIGENT SCENT MACHINE

USER MANUAL

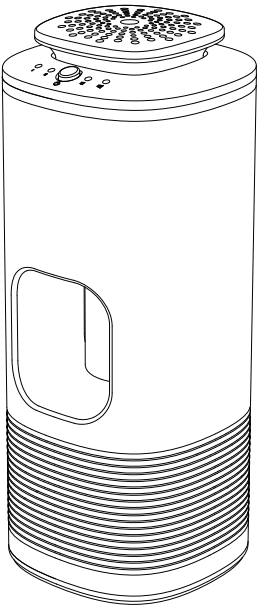

Please read the manual carefully before use and keep it properly

Please read carefully before use and keep it properly.
We supply warranty within 12 months after purchase date for all qualified machines.

Operation

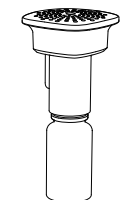

①Take out the atomizer head and essential oil bottle

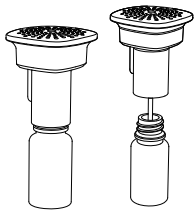

②Rotate the oil bottle out in a clockwise direction,fill the oil then rotate the bottle back in anti-clockwise direction.

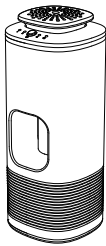

③Put the atomizing head back into the device

Packing

Equipment x1、 USB power cord x1、 Bottle x1、 Atomization core x1、 User Manual x1

Light description

- ① ② ③ ④ is the working gear indicator
- ① ② ③ ④The indicator lights indicate the charging status at the same time. When charging is turned off, the four indicator lights will flash from ① to ④, and stop flashing when fully charged; when charging, the indicator for the current position of the machine flashes , When the battery is fully charged, it stops flashing; when the battery voltage is low, it flashes slowly, indicating that it needs to be recharged.

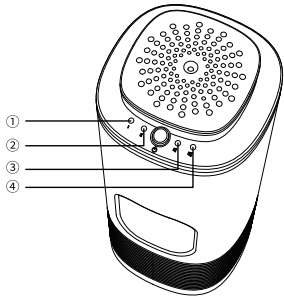

3. Atmosphere effect light:
State 1: When the device is plugged into the charger, the atmosphere effect light keeps on.
State 2: The atmosphere effect light turns on when it is not charging. When the start-stop function of the car is turned on, the atmosphere effect light shows a gradual change of color.
State 3: The atmosphere effect lamp is always on and works in the home mode, and it will automatically shut down until the end of the regular work.

Equipment Maintenance

If the equipment is not used for a long time, 95% industrial alcohol should be added into the refined oil bottle to clean the nozzle and other parts inside the equipment.Tip: Maintain the equipment with 95% industrial alcohol at least every 1-2 months.
Specific operation: add 95% industrial alcohol into the empty bottle, turn on the equipment and run for 10-15 minutes after , then turn off the equipment and pour the alcohol, then screw back the bottle to machine.

Car and Home Use Instruction

When the device is turned on, the device has the priority to turn on the on-board start-stop function by default. It will be used until the battery is exhausted and shut down. Press and hold the button for 6 seconds. The red atmosphere effect light flashes twice to turn off the on-board start-stop function. The device will enter the home for 8 hours. Working mode (automatic shutdown after 8 hours of work); long press the button again for 6 seconds, the green ambient light flashes twice, restart to enable the start-stop function of the car.

Key Function

- A** Single press the button to turn on, and the spray work and atmosphere effect lights are turned on at the same time.
- B** After turning on, press the button once to turn on the spray function, and the corresponding microwave induction function will be automatically turned on. Press one, two, three, four times to manually cycle to switch gears, and press the fifth working gear to indicate that the indicator light goes out The device is off.
Level 1: Open for 2 seconds, stop for 200 seconds, corresponding ① The indicator light is on and flashes when charging.
Level 2: Open for 3 seconds, stop for 200 seconds, the corresponding ② indicator light is on and flashes when charging.
Level 3: open for 4 seconds, stop for 200 seconds, the corresponding ③ indicator light is on and flashes when charging.
Level 4: open for 5 seconds, stop for 200 seconds, corresponding ④ indicator light is on, flashing when charging.
- Note: The four gears flash when the charger is not plugged in, which means the battery is low and stop flashing when fully charged.**
- C** Microwave induction: After the car is started, when the device is turned on, the device will automatically sense the spray state of the corresponding gear and light up the atmosphere effect light at the same time; when the car is turned off, the device will automatically sense the spray stop function and turn off the atmosphere effect light; no When it is detected that the car is working, the atmosphere effect light will briefly sleep.

Product Parameter

Size: W64xD64xH161mm	Weight: 0.22kg
Voltage: DC5V/1000MA	Capacity: 10ml
Power: 2W	Coverage: 10-50 m³

Change the Atomization Core

The atomization head combination is divided into: oil bottle, oil suction tube, filter, atomization core, first open the atomization head cover, take out the mist sheet, then pull out the atomization core to replace with a new atomization core, and install them in sequence Return the fog sheet and cover the atomization head cover.

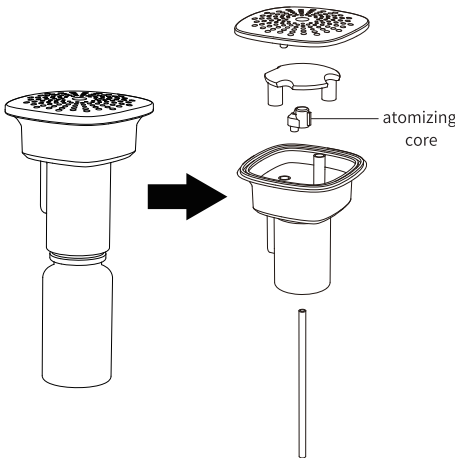

Warranty

- 1.The Warranty is suitable for new machine but not resell or second hand products.
- 2.Within 12 months after purchase date, Warranty is offered for all qualified machines. During warranty,we will offer repair services and the free parts but without essential oil.
- 3.The warranty card & purchase Invoice are needed if after service required. Please contact with us within warranty if any problems.
- 4.The following is not for free warranty service:
 - ①Damage & problems caused by Accidents & Fire.
 - ②Not use properly and wrong operation.
 - ③If repaired by not professional person and make some parts damaged.
 - ④Damaged during transportation.
 - ⑤Without our warranty card.
 - ⑥Without proper cleaning for a long time
 - ⑦The machine work time out.
 - ⑧Machines & Parts not from us.
 - ⑨Machines not gotten from official channels.
 - ⑩Send the machines back without permit from manufacturer.

Notice

1. Please read this manual carefully before using this product and keep it properly;
2. It is recommended to manually turn on and off the device once a week to calibrate the accuracy of the device's sensing;
3. The equipment must be kept upright when it is loaded with essential oil, and cannot be upside down or tilted to avoid oil leakage; 4. Do not use a power supply with a voltage exceeding DC5V to power the equipment to avoid damage to the equipment;
5. If you do not use the device for a long time, please turn off the device manually and be in a fully charged state;
6. Please do not try to open the inside of this product. If you find that the product is abnormal, please contact us in time.